

## How to add texture to walls

1. Login to your **Foyr | Neo** account on [www.foyr.com/neo](http://www.foyr.com/neo) or get an account simply by signing up (Hyperlink to show 'How to sign up').
2. Use the '**Wall**' tool or '**Room**' tool to draw walls on the canvas.  
**Note:** The nib-shaped **Wall** tool on the top row of the page helps you draw walls (as circled below).  
**Room** tool helps you draw square or rectangular walls on a floor plan.  
To know more about how to draw walls [CLICK HERE](#).

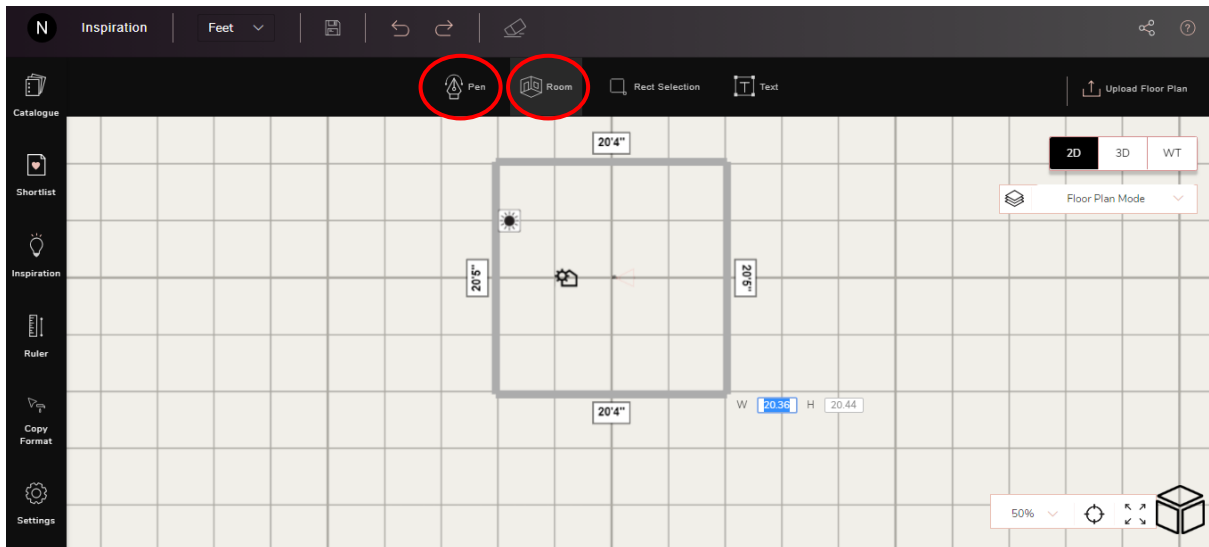

3. To add texture to the walls, click on '**Catalogue**' on the top left column of the page and select '**Texture**'.

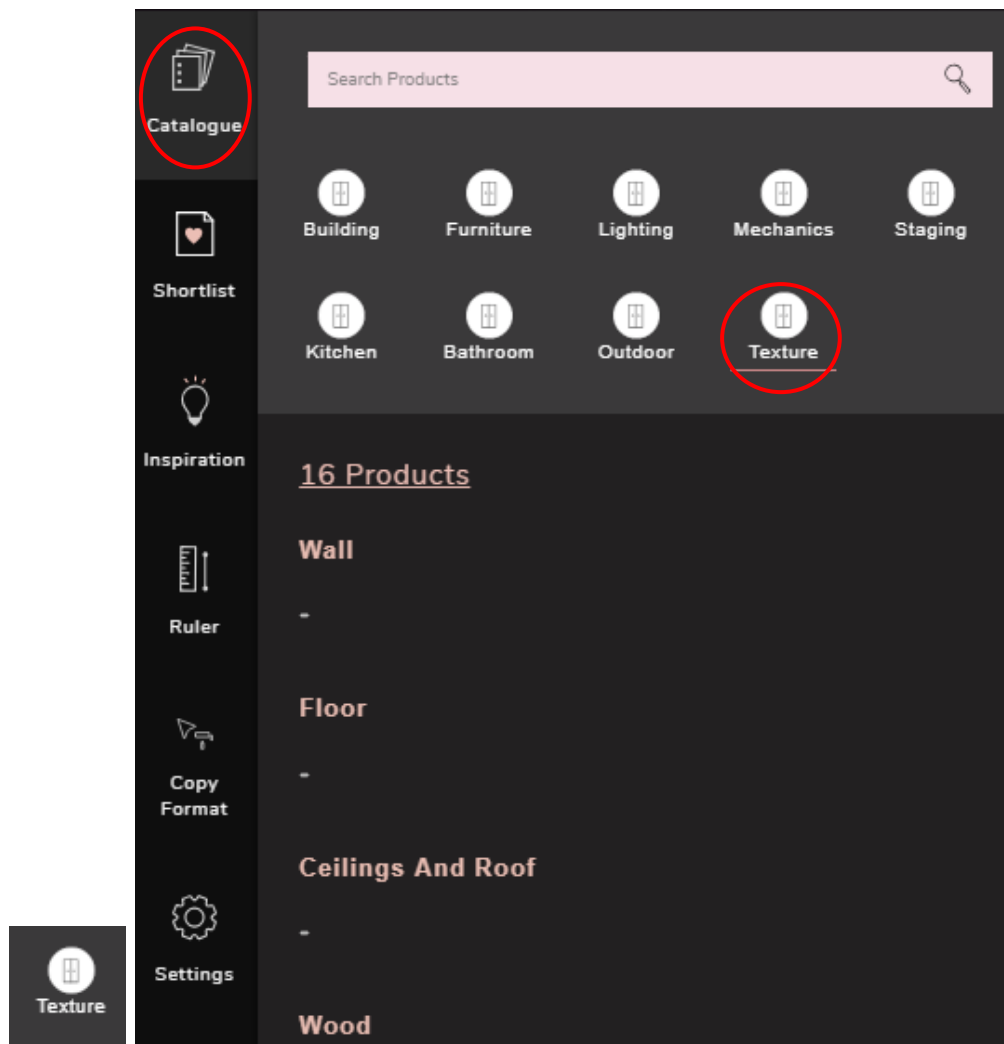

4. Click on **Wall** to view various textures.

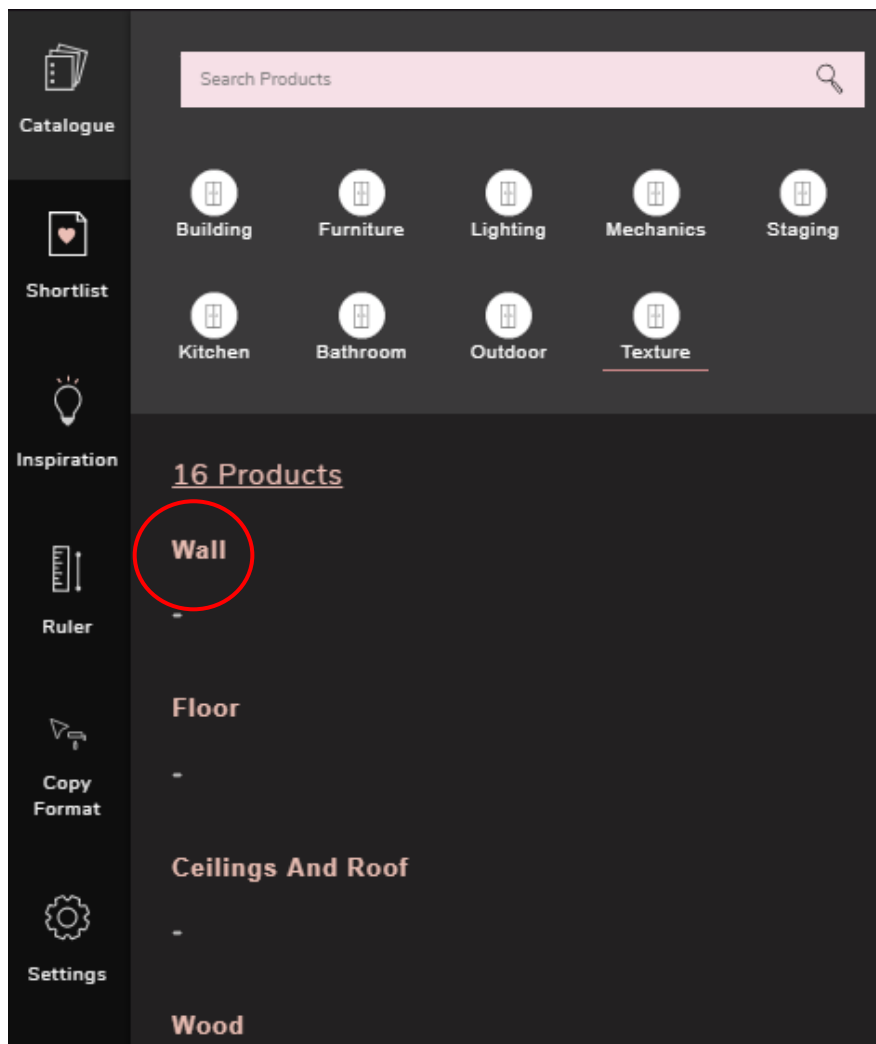

5. Select the **texture** of your choice and click on the white '**heart**' shape on the right of the image.

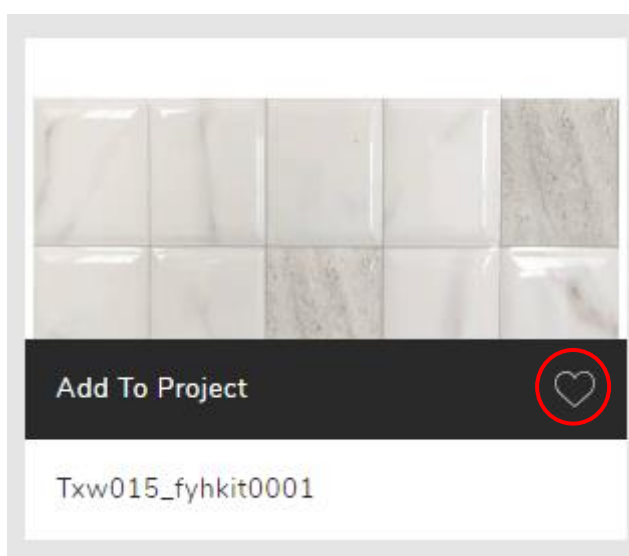

6. You will notice that once you click on the heart it turns pink in colour. This indicates that the product is **added to your project**.

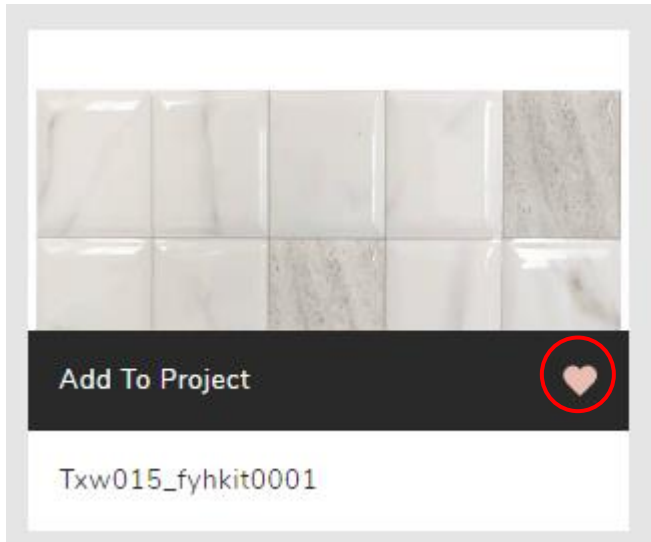

7. Click on 'Back' arrow on the top row of the page to go back to the canvas.

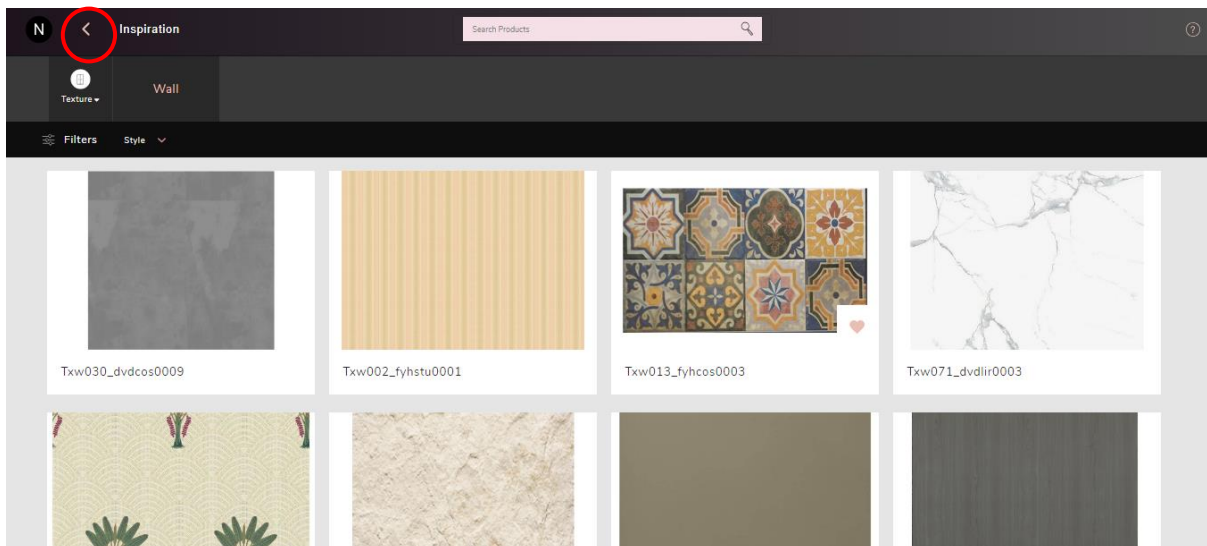

8. Change the canvas mode to **3D** on top right corner of the page.

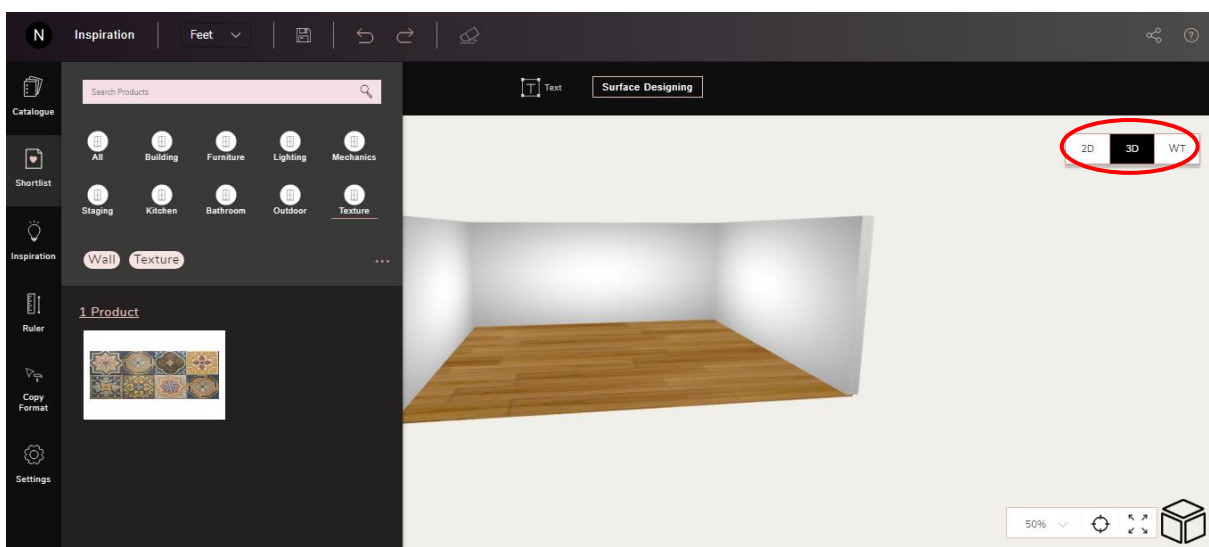

- Click on '**Shortlist**' on the left-hand side of the column and **drag and drop** the texture on the requisite wall.

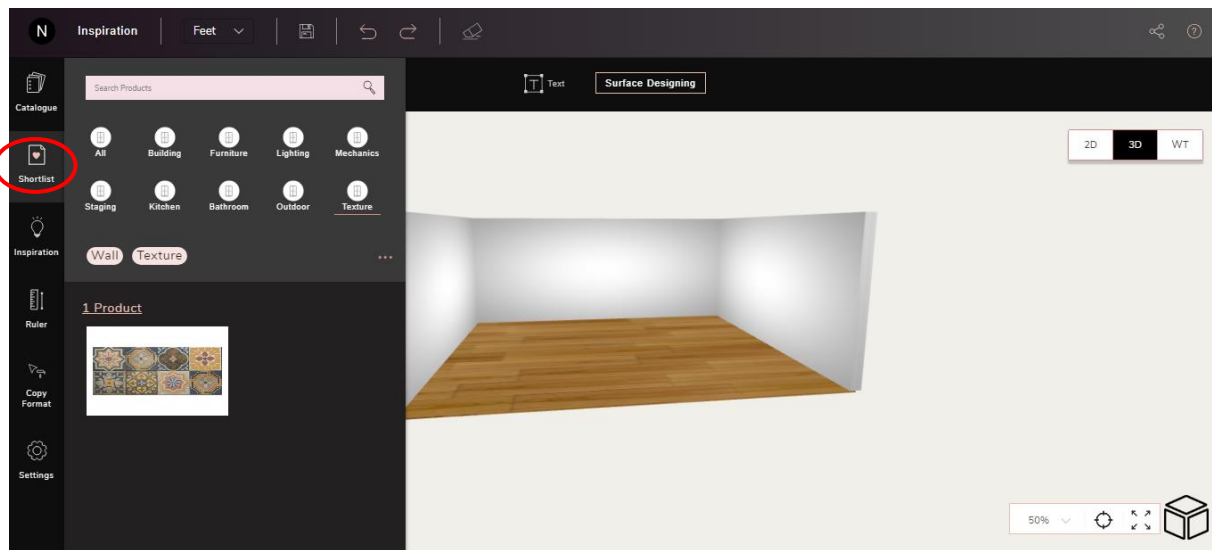

- Texture has been added.

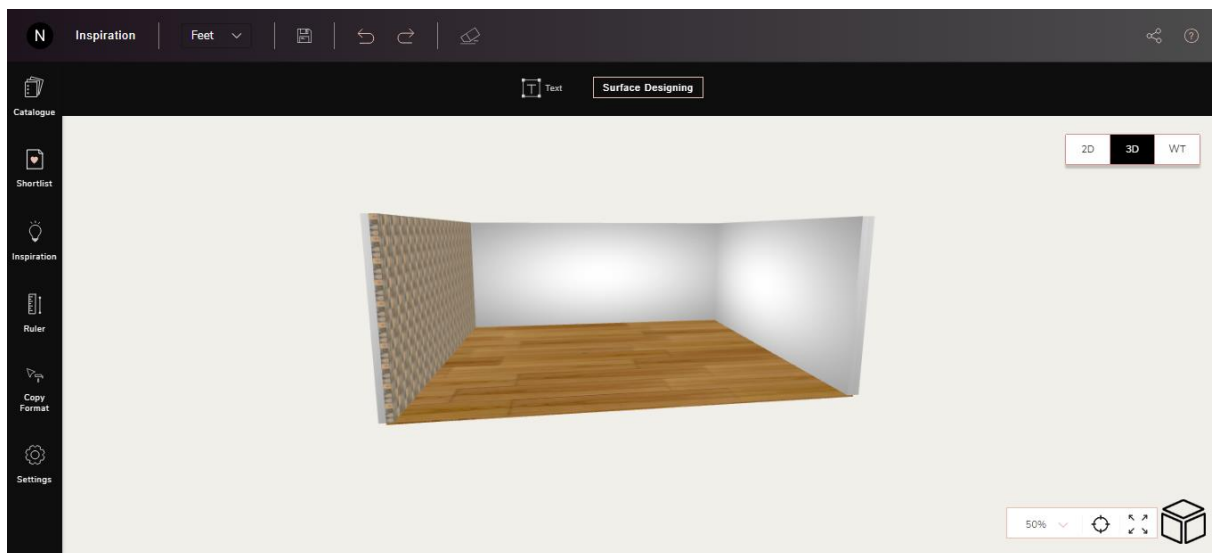

We hope this step-by-step guide on '**How to draw add texture to walls**' helped you understand this useful feature in **Foyr | Neo**. For any queries or questions feel free to contact us at xxx.